

**50-18080KIT - Front Windshield  
KAWASAKI TERYX H2**

**SEIZMIK<sup>®</sup>**

**HIGHLIFTER**

**SEIZMIK<sup>™</sup>**



 [service@seizmik.com](mailto:service@seizmik.com)

 1-866-838-3366  
between 9:00 AM and 5:00 PM EST.



[www.seizmik.com/customer-support](http://www.seizmik.com/customer-support)

Parts Available For These Popular Brands and Others

**POLARIS**

**can-am**



**HONDA**

**Kawasaki**

 **YAMAHA**

## PRODUCT INFORMATION

Seizmik®, the leader in manufacturing Windshields, Mirrors, Door Kits, Racks, and other great accessories for UTVs brings you the innovative, new Seizmik® Front Windshield, to help you do what you do, better. This product does not require any modifications to your vehicle and fits the Kawasaki H2.

**Familiarize yourself with all the steps before beginning assembly.**

If you have any questions, comments, need assistance, or are missing parts, please visit our website <http://seizmik.com/customer-support> Or email us at [service@seizmik.com](mailto:service@seizmik.com). Visit [www.seizmik.com](http://www.seizmik.com) for more information on our product or call 1-866-838-3366 between 9:00AM and 5:00PM EST.

## INCLUDED INSIDE THE BOX:

Item	Part No.	Description	QTY
1	50-18080	Windshield (Pre-installed)	1
2	54-96024	Front Vent (Pre-installed)	2
3	54-90069-F	Gasket (Pre-installed)	12ft
4	54-96020R	Vent Rear Right (Pre-installed)	1
5	54-96020L	Vent Rear Left (Pre-installed)	1
6	54-61043	8mm x 1.25 Nut	2
7	54-90145	Button Head Hex Drive Screw, M8 x 35mm	2
8	54-96513	8.4 x 20 x 8mm Spacer	2
9	54-96032	Clamp Assembly, 2" Seizmik Tool-less Windshield (Pre-installed)	4

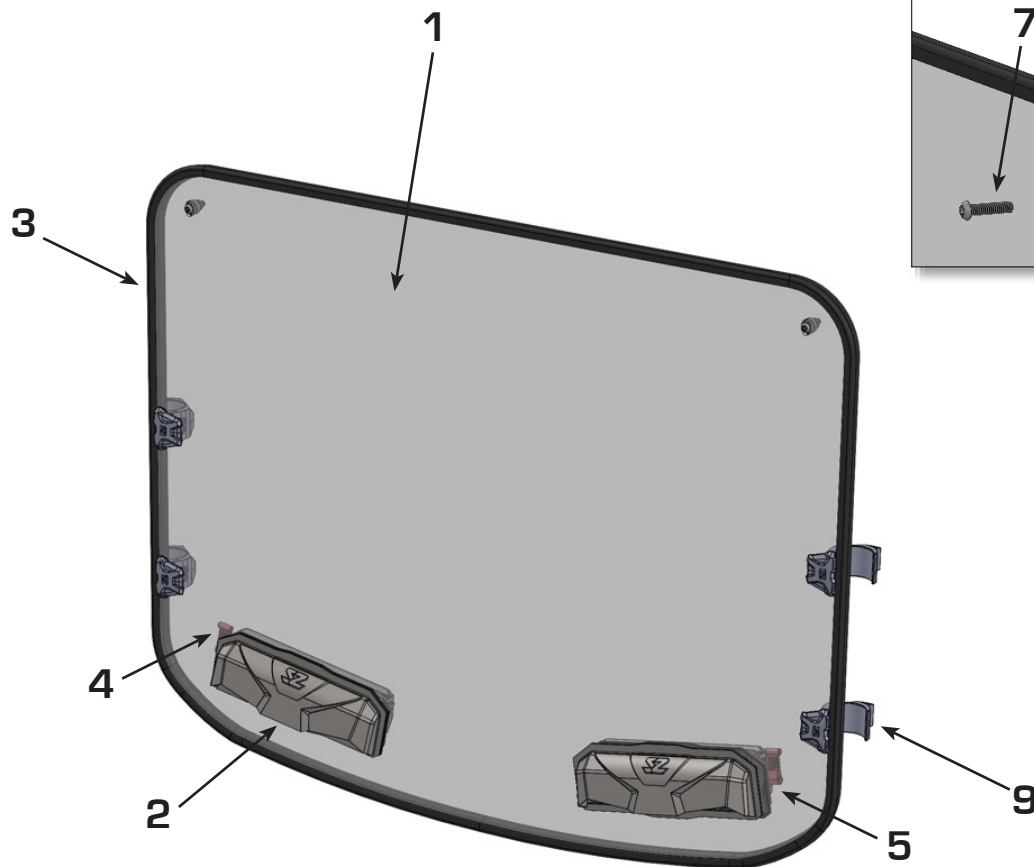

## ASSEMBLY INSTRUCTIONS FOR FRONT WINDSHIELD

**STEP 1:** Remove the Roof Bolts in the top right and top left corner. This will allow you access to lift up the roof to install the windshield.



**STEP 2:** Place a block in between the frame and the roof to keep the roof up. This will allow a little more room for installing the bolts.

**STEP 3:** Install the windshield onto the vehicle and up under the roof line, take the plastic spacer provided in the kit and place it between the windshield and the window frame as shown. This will need to be done in both corners.



**STEP 4:** Install the bolt through the windshield, spacer and vehicle frame as show. Fasten with the Nylock Nut provided in your kit from the inside. Do not fully tighten until both sides have the bolts through the frame, then fully tighten.



**STEP 5:** Snap the clamps to both of the A-pillars.



**STEP 6:** Reinstall the roof bolts and you're ready to roll!

**INSTALLATION COMPLETE**